

3/4" Memory BOREHOLE TEMPERATURE GAUGE



The **BHT-750** is a Versatile, Durable and Accurate Memory Borehole Temperature Gauge. This versatile temperature tool can be used on Slickline, Wireline and Coil Tubing. It's small diameter, short length and high temperature rating (**350°F**) make this unique tool ideal for almost any situation.

Benefits

- High Capacity Flash Memory
- High Temperature Rating
- Ability to stay in the well for extended periods of time
- Custom program up to 14 time periods
- Tool performs internal tests and delivers visual signal to confirm
- Multiple-run data storage capability

Length	13.25 in. (33.65 cm)
Weight	<1 lb. (.45 Kgs)
Diameter	3/4 in. (1.9 cm)
Housing Material	Inconel 718

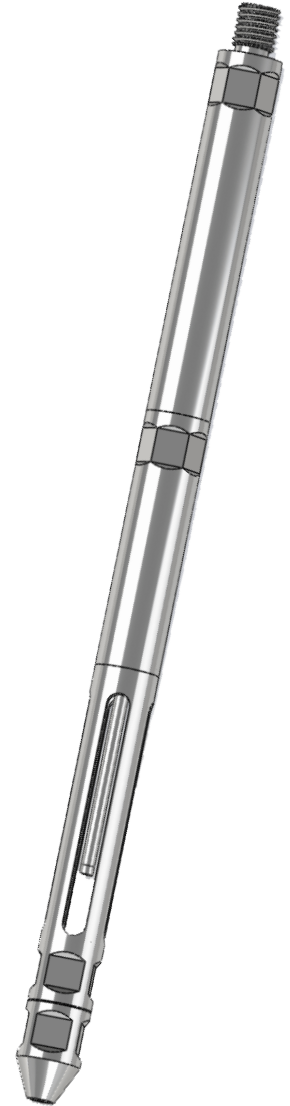

Memory Capacity	500,000 data sets (Time, Borehole Temp.)
Sampling Intervals	1 sec to 1 hr
Operating Pressure Range	15,000 psi (103,421 kPa)
Operating Temperature	32°F to 350°F (0°C to 177°C)
Resolution	Temperature - 0.01°F (0.006°C)
Accuracy	Temperature ± 1°F (0.6°C)
Power	3.6V (1- 'AA' Cell Lithium)